

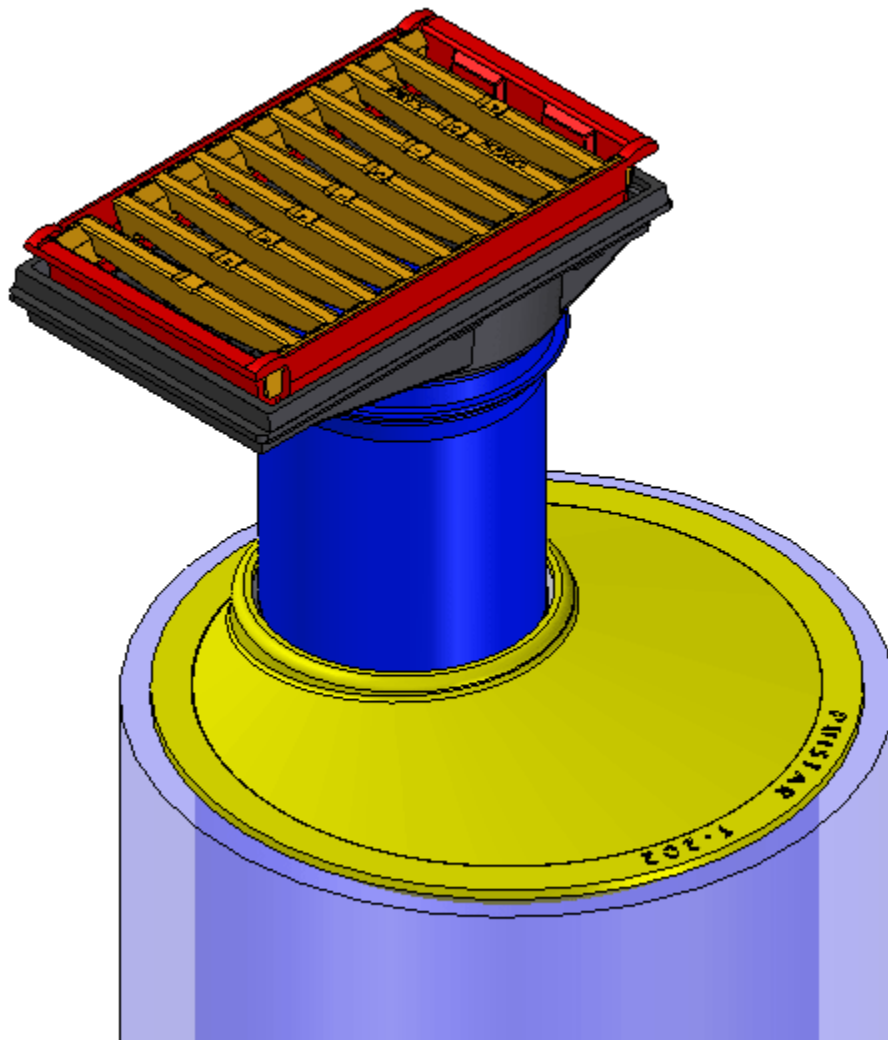

A LONG-AWAITED SOLUTION!



PUISTAR, the new catch **basin** for **roads and streets**. An intelligent catch basin designed to meet all your road infrastructure requirements.

**A MILESTONE EVENT
IN PUBLIC INFRASTRUCTURES**

PUISTAR—AN INNOVATIVE CONCEPT

The Puistar system is a set of adjustable, watertight components that puts an end to erosion and subsidence problems and ensures optimum catchment and evacuation of runoff. All Puistar components were rigorously studied in order to eliminate the numerous problems encountered with conventional catch basins. Thanks to its unique universal adapter seal, Puistar fits road surface elevation and slope perfectly. Each year, municipalities, road departments and parking lot managers spend considerable sums of money repairing and replacing catch basins. The reason why? As currently designed and installed, catch basins invariably generate problems that are aggravated by the climate.

PUISTAR—AN EFFECTIVE SOLUTION

Problem : grate height and slope are improperly adjusted to road surface → uneven, unsafe road surface; grates stripped from street during snow removal operations.

THE PUISTAR SOLUTION : double-lock grate is always installed to fit road slope.



Problem : uneven compacting around catch basin → road subsidence around grate.

THE PUISTAR SOLUTION : installation requires even compacting around catch basin and on grate.



Problem : no room for repositioning in the event of a discrepancy between plans and worksite conditions → improperly located catch basin; inefficient catchment.

THE PUISTAR SOLUTION : frame and head can be rotated, creating a potential for adjustment of up to 8 inches



Problem : lack of watertightness between concrete head and frame → water seepage and deterioration triggered by the frost-thaw cycle.

THE PUISTAR SOLUTION : watertight vertical outlet eliminates seepage.



Problem : repeated shocks generated by road traffic are conveyed directly to concrete base of catch basin → cracking of concrete structures and accelerated deterioration of catch basin.

THE PUISTAR SOLUTION : thanks to floating frame independent of base, shocks are absorbed by road infrastructure, not by catch basin.

EASY, ECONOMICAL INSTALLATION

In contrast with some innovations that require users to modify customary work methods, often at great expense, the Puistar catch basin system installs in a snap, requiring no special tools or procedures. Contractors will thank you for making life easier for them. The Puistar catch basin adjusts to all worksite conditions, thus speeding up installation and eliminating stopgap solutions that always lead to expensive repairs. You're sure to see improvement in work quality, durability of results and drainage performance. Puistar fits all existing concrete bases, making it the ideal replacement solution for upgrading an entire catch basin network.

THE PUISTAR SYSTEM

GRATE

Bar design ensures maximum catchment of storm water. A double-lock safety system keeps grate firmly in place.

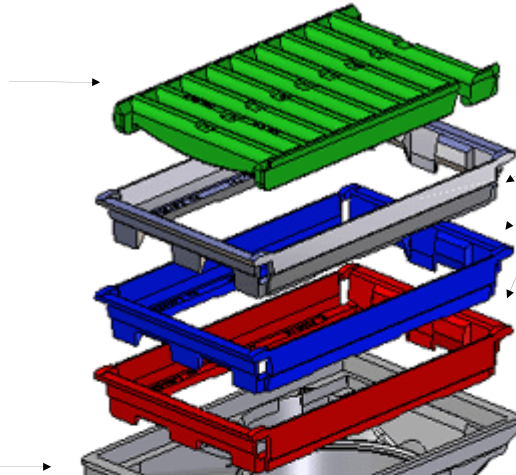

ADAPTER

This frame component supports grate and is set in even with road surface elevation regardless of street slope or asphalt thickness.

CATCHMENT FRAME

Off-center form enables users to select optimum position according to specific conditions encountered.

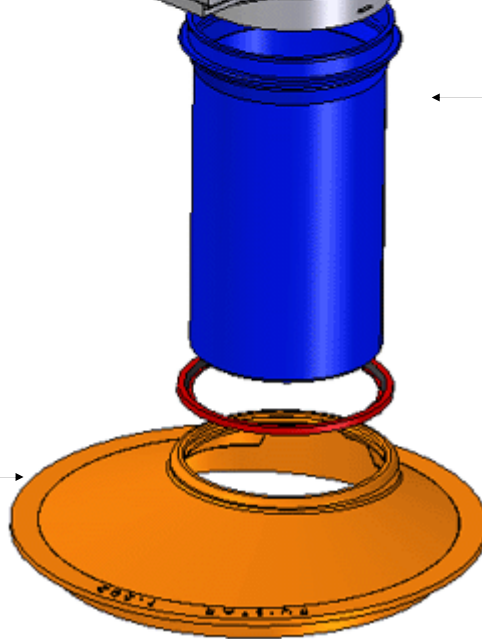

SLEEVE-GUARD

Ensures watertightness of seal between catchment frame and basin head. Channels water directly to bottom of catch basin. Allows adjustment to a full range of depths and slopes.

HEAD

Adapts to all conventional concrete bases. Head's particular geometric form combines with unique shape of catchment frame to produce pinpoint adjustments.

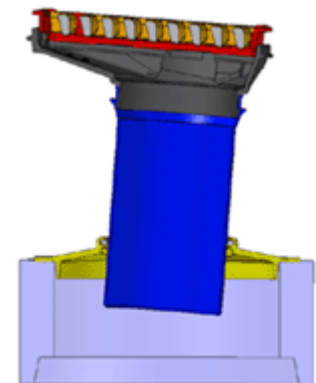

DIAGRAMMATIC SECTION

TECHNICAL FACT SHEET

SYSTEM COMPONENTS

Part no.	Item	Dimensions	Weight	Materials
G – 103	Grate	610 x 368 x 64mm	89 pds	Ductile iron
CA – 103 - 40	Adapter	676 x 396 x 40mm	29 pds	Ductile iron
CA – 103 - 50	Adapter	676 x 396 x 50mm	31.5 pds	Ductile iron
CA – 103 - 60	Adapter	676 x 396 x 60mm	34 pds	Ductile iron
CC – 103	Catchment frame	690 x 416 x 149mm	74.5 pds	Ductile iron
B - 102	Sleeve-guard	370Ø x 610mm	8 pds	Polyethylene
T - 102	Cast iron head	600Ø x 121mm	77.5 pds	Gray iron
T - 202	Cast iron head	750Ø x 121mm	128 pds	Gray iron
T - 302	Cast iron head	900Ø x 121mm	145 pds	Gray iron

Note: Grate, adapter and catchment frame fit into one another for easy delivery.

CERTIFICATIONS

TEST RESULTS

- Load tests in conformity with the BNQ 3221-500 standard.
Each system component successfully met this standard's requirements.
No break occurred during load under pressure of 535 KN, 120,000 lbf.

STANDARDS COMPLIED WITH

- Ductile iron A 536 (65 – 45- 12)
- Gray iron A 48
- ISO 9001: 2000 (manufacturing of gray and ductile iron castings)

PATENTS

- AMERICAN: 08/939,618
- CANADIAN: 2,212,401 CLASSIFICATION EO2D – 29/12

TESTED PRODUCT :

- The MTQ Guichet Unique of qualification of the products and suppliers confirmed that the **Puistar** product is considered to be a product that's been successfully tested (14-08-02).

The PUISTAR catch basin is designed and produced in Québec in accordance with the particular features of our infrastructures, installation methods and climate conditions.

PUISTAR INC.
256, rue de l'Affluent
Saint-Nicolas (Quebec) G7A 5A4
Tel. : (418) 806-5309 – Fax : (418) 831-5565
Web site : www.puistar.com – e-mail : info@puistar.com